

LINK LIGHT

Build your own LED Lighting solution



STARTER PACK Installation Guide



Scan QR-coden for
video installation guides

Made in Denmark by
LED LBOND



We reduce the climate footprint with
high-efficient LEDs, recyclable aluminum
and minimizes the use of plastic.

ENGLISH



Before you start your lighting project!

For each light run with LINK LIGHT (up to 18 LED spots), you must use one STARTER PACK.

You will need this for the installation:

For mounting LINK LIGHT on soft surfaces, e.g. wood:

- Screw machine or a screwdriver
- One 3 mm countersunk wood screw (length 20-30 mm) per mounting clip

For mounting LINK LIGHT on hard surfaces, e.g. concrete, brick:

- Screw machine or a screwdriver
- 5 mm masonry drill bit
- Rawplugs - 5 mm (one per mounting clip)
- One 5 mm countersunk screw (Length 25-35 mm) per mounting clip (I)

NOTE:



Use only submerged screws with a max. diameter of 7 mm.

STARTER PACK contains:

(A) Power cord



(B) LED-driver



(C) Power cable 230 VAC



(D) Power cord cover



(E) End cap



(F) Allen key



LINK LIGHT LED-panels contains:

(H)



60 cm eller 90 cm

(I)



X 2

(J)



X 2

(K)



X 2



Safety information



The LED light source in this LED panel cannot be replaced. When the LED light source reaches its lifetime, the entire LED panel must be replaced. The power supply must be replaced by the end user. When the power supply reaches its service life, the power supply must be replaced. LINK LIGHT must be installed in accordance with all applicable building regulations. It is recommended that an authorized electrician installs the LED-panel and the power supply. Fire hazard! The light sources must not be covered. Always turn off the power before installation, maintenance or repair.

Installation

Scan and watch video installation guide:



LED driver setting

1 **IMPORTANT:** Count the **total** number of LED-spots in the panels you want to connect to the power supply.

2 According to the total number of LED-spots set the 4 switches on the LED-driver.

NOTE:

Recommended settings ensure light uniformity and optimized durability. The level of mA control the watts per spot - see table on power supply.

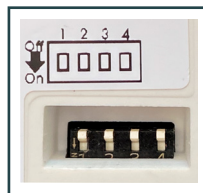

LED-spots (number)	Switch			
	1	2	3	4
3-4	-	-	-	-
5	on	-	-	-
6	-	on	-	-
7	on	on	-	-
8	-	-	on	-
9	-	on	on	-
10	on	on	on	-
11	-	-	-	on
12	on	-	-	on
13	-	on	-	on
14	on	on	-	on
15	-	-	on	on
16	on	-	on	on
17	-	on	on	on
18	on	on	on	on

Installation of LED panels

3 Screw the mounting clips (I) up to the required number of panels is used in the light sequence and click the LINK LIGHT LED-panel firmly - one side at a time.

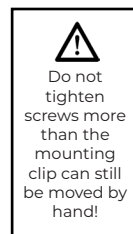
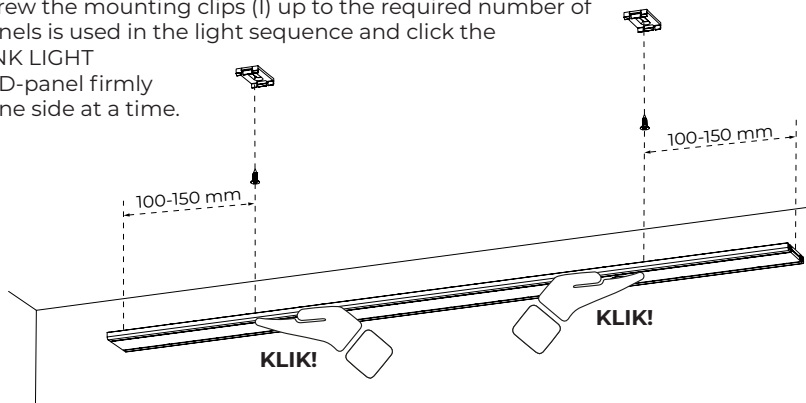

4 How to connect LINK LIGHT LED-panels

- if your light solution consists of more than one LED panel

4a Screw the sockets (J) fully into the panel with the Allen key (F).

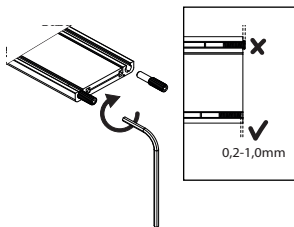

4b Insert pins (K) in the sockets.

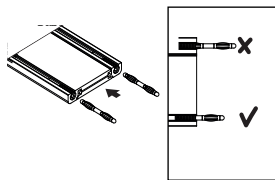

4c Slide the panels together as they are mounted on the mounting clips (I).

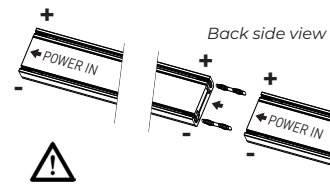

IMPORTANT: place panels so + is on the **same side** throughout the entire light run!

5 Plug in the Power cord

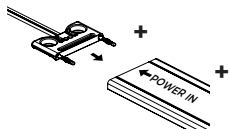

6 Cut notch in power cord cover (D) on the end side or on the side.

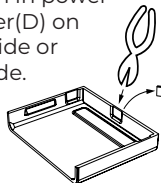

7 Click (D) on power cord cover.

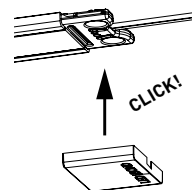

8 Mount the end cap (E).

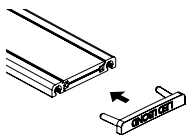

9 Connect the 230V mains plug (C) from the LED driver to the socket and switch on.



DONE. ENJOY!

